

제 57차

대한비만학회 춘계학술대회

Rethinking Obesity as A Disease

2023. 3. 17(금) - 18(토)

그랜드 워커히 서울, 비스타홀(B2)

Program book



PROGRAM AT A GLANCE

시간 / 장소	VISTA Hall (B2)			Grand Hall (B1)	
	Room 1	Room 2	Room 3	Room 4	Room 5
Day 1. 3월 17일 금요일					
14:50-16:20	보령법제위원회 Special Symposium 비만의 사회적 및 의료적 관점의 문제점과 해결방안				
16:20-16:30	Break				
16:30-18:05	소아·청소년 비만 문제 법제와 추진을 위한 대한비만학회와 대한당뇨병연합 공동 심포지엄				
18:05-18:30	Break				
18:30-19:00	Satellite Symposium 1				
19:00-19:10	Break				
19:10-19:40	Satellite Symposium 2				
19:40-			Welcome Reception		
Day 2. 3월 18일 토요일					
08:00-08:45	Breakfast Symposium 1	Breakfast Symposium 2	Breakfast Symposium 3		
08:45-08:50	Opening				
08:50-10:20	Symposium 1	Symposium 2	Symposium 3	Oral Presentation 1	
	Treatment of Obesity	Integrative Physiology and Molecular Mechanisms of Obesity	Postprandial Glycemic Response and Continuous Glucose Monitoring		
10:20-10:30	Break				
10:30-12:00	Symposium 4	Symposium 5	Symposium 6	Poster Exhibition	
	Environmental, Genetics and Obesity	Gut Microbiome	Digital Therapeutics in Obesity Management		
12:00-12:30	Luncheon Lecture 1				
12:30-13:00	Luncheon Lecture 2				
13:00-13:50	Plenary Lecture				
	Obesity and Hypothalamic Innate Immune Responses to Fat-Rich Diets				
13:50-14:00	Break				
14:00-15:30	Symposium 7	Symposium 8	Symposium 9	Oral Presentation 2	
	New Drug to Battle Obesity-related Diseases	Metabolic Surgery	Obesity Treatment in Adolescent		
15:30-15:40	Break				
15:40-16:10	Keynote Lecture 1		Keynote Lecture 2		
	Does Obesity Promote Aging? : Physical Activity and the Role of Telomeres		Measures to Stay Healthy		
16:10-17:40	Symposium 10	Symposium 11	Symposium 12		
	Comorbidity of Obesity	Big Data in Obesity Research	Exercise, Obesity, and Metabolic Dysfunction		
17:40-18:00	Award & Closing				

제 57차 대한비만학회 춘계학술대회

Rethinking Obesity as A Disease

학회장 배치도

PROGRAM AT A GLANCE

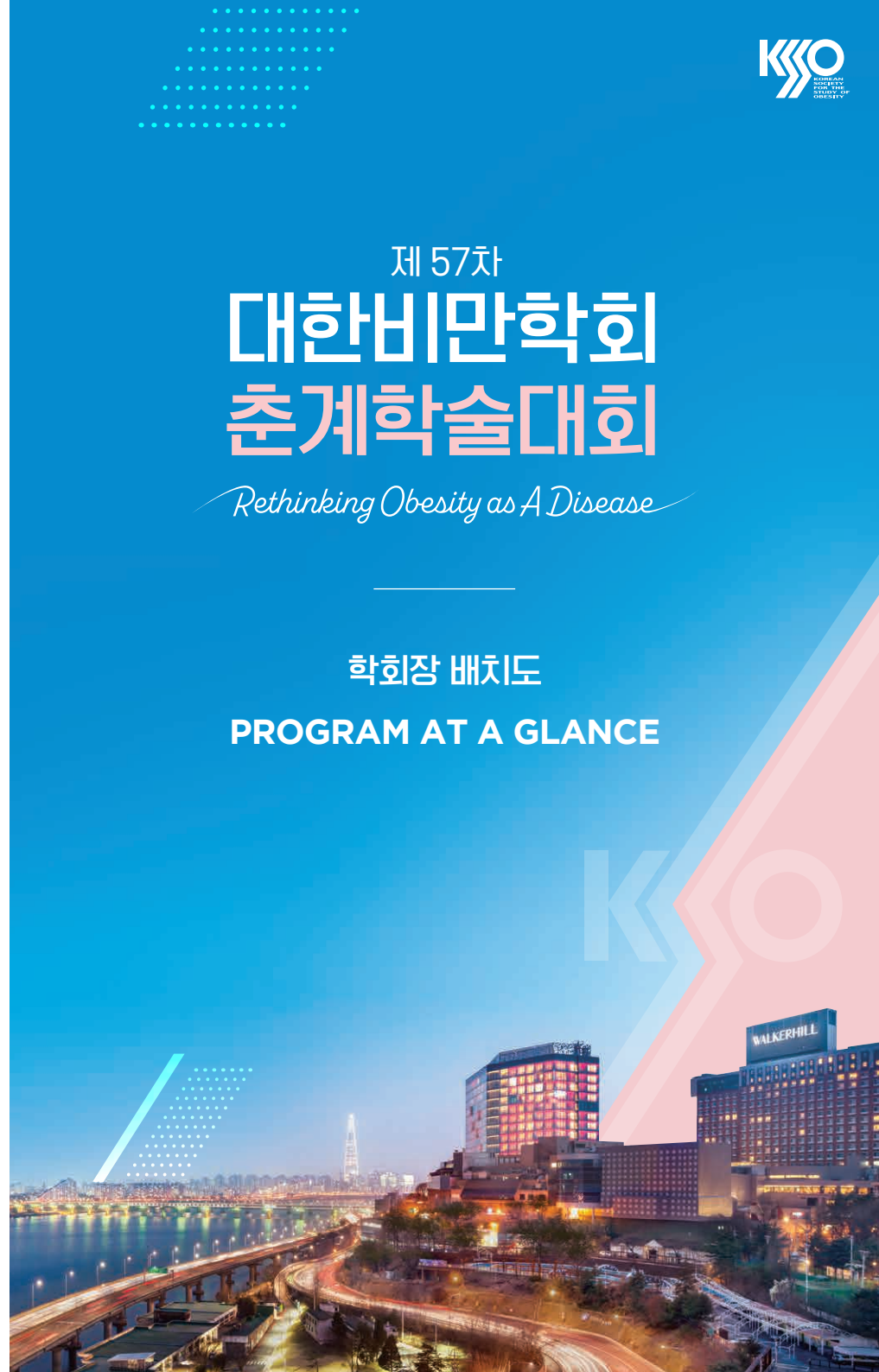

학회장 배치도 (B1)

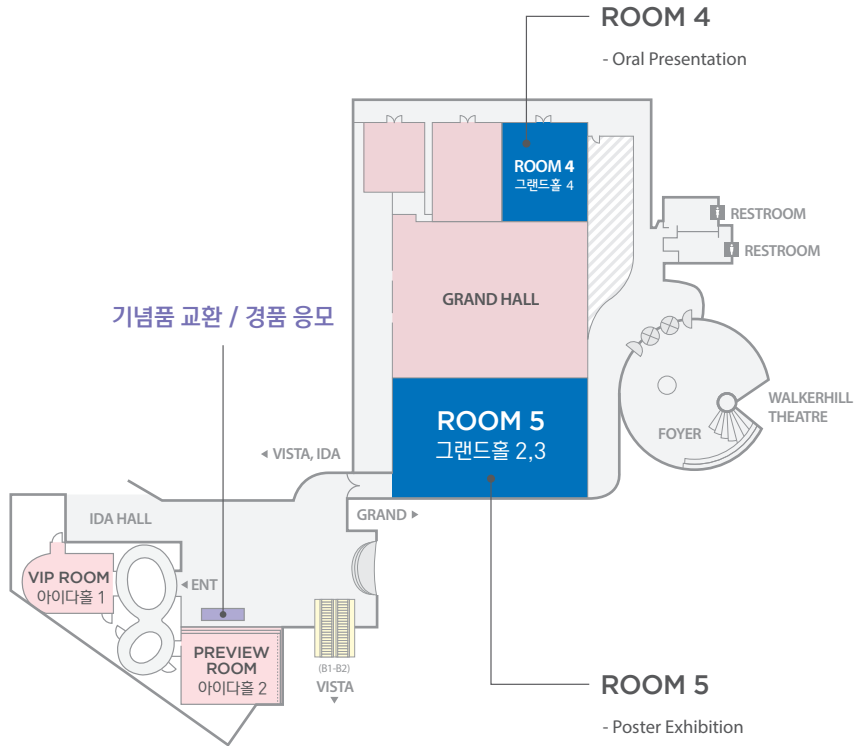

제 57차 대한비만학회 춘계학술대회

학회장 배치도 (B2)



ROOM 1

- Opening
- Award & Closing
- Plenary Lecture
- Keynote Lecture 1
- Symposium 1,4,7,10
- Breakfast Symposium 1
- Luncheon Lecture 1,2
- Satellite Symposium 1,2
- 보힘법제위원회의 Special Symposium
- 소아·청소년 비만 문제 법제와 추진을 위한 대한비만학회와 대한당뇨병연합 공동 심포지엄

ROOM 2

- Opening
- Award & Closing
- Plenary Lecture
- Symposium 2,5,8,11
- Breakfast Symposium 2
- Luncheon Lecture 1,2

ROOM 3

- Opening
- Award & Closing
- Welcome Reception
- Plenary Lecture
- Keynote Lecture 3
- Symposium 3,6,9,12
- Breakfast Symposium 3
- Luncheon Lecture 1,2

Rethinking Obesity as A Disease

제 57차

대한비만학회 춘계학술대회

Contents

모시는글

대한비만학회 임원진

대한비만학회 학술위원회

학회장 배치도

Program at a Glance

Daily Program

→ Day 1. 3월 17일(금)

→ Day 2. 3월 18일(토)

Poster

참가안내

후원/전시

제 57차

대한비만학회
춘계학술대회

Rethinking Obesity as A Disease

인사말

회원 여러분 안녕하십니까?

지금은 코로나19를 포함한 감염질환과 비만을 비롯한 만성질환의 위험도가 동시에 증가하는 유례없는 시대입니다.

질병관리청의 국민 건강영양조사 결과를 기반으로 한 비만 심층 보고서에 따르면 19세 이상 성인 남성은 전 연령에서 2008년 이후 매년 비만 유병률이 약 2%씩, 2단계 이상의 비만 유병률은 약 6%씩 증가하는 것으로 나타났습니다. 이처럼 코로나19의 긴 터널을 지나오면서 비만은 우리의 일상에 심각한 문제로 대두되고 있습니다.

대한비만학회는 지난해 30주년을 맞이하여 「사회적 책임을 다하는 비만 연구」와 「치료의 세계적 리더」라는 비전을 제시하였습니다. 이를 위해 우리 학회는 향후 다양한 분야의 전문가들이 참여하여 의견을 나누는 축제의 장을 만들고자 합니다.

이번 춘계 학술대회에서는 최고의 강사들을 모시고 비만학 전반의 최신 지견을 심도 있게 다룰 예정입니다. 본 프로그램에는 비만의 신경 내분비 대가이신 김민선 교수님의 Plenary Lecture를 중심으로 소아청소년 및 운동 비만연구 분야에서 오랜 기간 연구해오신 정소정, 신윤아 교수님의 Keynote Lecture가 준비되어 있습니다. 또한 역학 및 기초연구 분야뿐만 아니라 약물, 식사, 운동, 행동 치료의 최신 내용들도 망라하였습니다.

반가운 꽃망울이 봄의 시작을 알리고 우리를 설레게 하듯이 이번 학술대회에서도 많은 회원들이 참석하여 반가운 얼굴들을 만나고 학문적 교류의 기회를 가지시길 바랍니다.



김 성 수
대한비만학회 회장



박 철 영
대한비만학회 이사장



대한비만학회 임원진

회장

김 성 수 충남의대 가정의학과

부회장

김 경 곤 가천의대 가정의학과

김 은 미 강북삼성병원 영양팀

신 윤 아 단국대 국제스포츠학부

이사장

박 철 영 성균관의대 내분비내과

총무이사

홍 상 모 한양의대 내분비대사내과

부총무

김 경 수 차의대 내분비내과

조 윤 경 울산의대 내분비내과

류 영 상 조선의대 내분비대사내과

박 계 영 한양의대 가정의학과

배 재 현 고려의대 내분비내과

홍 준 화 을지의대 내분비내과

한 병 덕 고려의대 가정의학과

학술이사

임 수 서울의대 내분비내과

편집이사

황 유 철 경희의대 내분비내과

연수이사

강 지 현 건양의대 가정의학과

연구(임상)이사

손 장 원 가톨릭의대 내분비내과

연구(기초)이사

김 기 우 연세치대 구강생물학교실

교육이사

고 혜 진 경북의대 가정의학과

언론·홍보이사

허 양 임 차의대 가정의학과

기획이사

김 상 용 조선의대 내분비대사내과

대외협력정책이사

박 정 환 한양의대 내분비대사내과

재무이사

이 기 영 가천의대 내분비대사내과

정보이사

조 윤 정 대구가톨릭의대 가정의학과

국제협력이사

정 창 희 울산의대 내분비내과

개원이사

이 창 현 서울행복내과

보험법제이사

남 가 은 고려의대 가정의학과

IT융합 대사중후군 치료이사

이 상 열 경희의대 내분비대사내과

진료지침이사

권 혁 태 서울의대 가정의학과

식품영양이사

임 정 현 서울대병원 급식영양과

운동이사

김 중 희 한양대 스포츠산업과학부

행동치료이사

한 창 우 명지병원 정신건강의학과

비만대사수술이사

한 상 문 서울의료원 외과

소아청소년이사

홍 용 희 순천향의대 소아청소년과

빅데이터이사

한 경 도 숭실대 정보통계보통수리학과

비만교과서 TFT 팀장

권 혁 상 가톨릭의대 내분비내과

감사

강 준 구 한림의대 내분비내과

정 소 정 건국의대 소아청소년과

대한비만학회 학술위원회

학술이사

임 수 서울의대 내분비내과

학술부위원장

손 장 원 가톨릭의대 내분비내과

학술간사

홍 준 화 을지의대 내분비내과

김 진 옥 히포크라타의원

학술위원

문 준 성 영남의대 내분비대사내과

이 승 환 가톨릭의대 내분비내과

정 창 희 울산의대 내분비내과

윤 지 완 서울의대 내분비내과

배 재 현 고려의대 내분비내과

이 경 애 전북의대 내분비대사내과

박 경 희 한림의대 가정의학과

남 가 은 고려의대 가정의학과

오 범 조 서울의대 가정의학과

조 윤 정 대구가톨릭의대 가정의학과

권 혁 태 서울의대 가정의학과

구 혜 연 서울의대 가정의학과

최 형 진 서울의대 해부학교실

이 윤 희 서울대 약대

임 현 정 경희대 식품영양학과

김 오 연 동아대 식품영양학과

송 수 진 한남대 식품영양학과

김 일 영 가천의대 분자생물학과

김 재 현 서울의대 소아청소년과

홍 용 희 순천향의대 소아청소년과

이 민 철 차의대 스포츠의학과

이 세 원 인천대 체육학부



제 57차

대한비만학회
춘계학술대회

Rethinking Obesity as A Disease



제 57차

대한비만학회 춘계학술대회

Daily Program

- Day 1. 3월 17일(금)
- Day 2. 3월 18일(토)



보험법제위원회 Special Symposium

14:50-16:20 **비만의 사회적 및 의료적 관점의 문제점과 해결방안**

Room1 R2 R3 R4

Chair(s)	김중화 (부천세종병원 내분비내과) 김성수 (충남의대 가정의학과)
14:50-14:55	개회사 김성수 (대한비만학회 회장)
14:55-15:00	환영사 박철영 (대한비만학회 이사장)
15:00-15:20	비만의 공중보건학적 관점의 문제점 허연 (울지의대 가정의학과)
15:20-15:40	비만대사수술 현황과 개선 방안 박영석 (서울의대 외과)
15:40-15:55	정부의 비만 정책 방향 이지현 (보건복지부 건강증진과)
15:55-16:20	Panel Discussion 박은자 (한국보건사회연구원) 윤영숙 (인제의대 가정의학과) 이장원 (건강보험심사평가원 의료수가개발부) 임정연 (서울대병원 급식영양과)

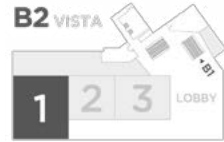

Break

16:20-16:30 **Break**

소아·청소년 비만 문제 법제화 추진을 위한 대한비만학회와 대한당뇨병연합 공동 심포지엄

16:30-18:05	소아·청소년 비만 문제 법제화 추진을 위한 대한비만학회와 대한당뇨병연합 공동 심포지엄	Room 1 R2 R3 R4
Chair(s)	강재현 (성균관의대 가정의학과) 안자희 (대한당뇨병연합 상임이사)	
16:30-16:35	개회사 김성수 (대한비만학회 회장)	
16:35-16:40	격려사 국회의원 서정숙 (보건복지위원회)	
16:40-16:45	격려사 국회의원 양정숙 (정무위원회)	
16:45-16:50	환영사 김광훈 (대한당뇨병연합 대표이사)	
16:50-16:55	환영사 박철영 (대한비만학회 이사장)	
16:55-17:10	우리나라 소아·청소년 비만 실태 홍응희 (순천향의대 소아청소년과)	
17:10-17:25	우리나라 소아·청소년·청년 당뇨병 실태 박혜련 (경일대 간호학과)	
17:25-17:40	소아·청소년 비만이 미치는 영향 (건강 문제 외에 비만이 소아·청소년 생활에 미치는 영향) 정소정 (건국의대 소아청소년과)	
17:40-18:05	Panel Discussion 홍여진 (고려대안산병원 영양팀) 강류교 (전국보건교사회 회장) 최경애 (한림대강남삼성병원 의료사회복지팀 팀장) 심영은 (한림대 대학원 식품영양전공) 정희권 (교육부 학생건강정책과 과장)	



Break

18:05-18:30 Break

Day 1. 3월 17일 금요일

Satellite Symposium 1

18:30-19:00 **Satellite Symposium 1**

Room1 R2 R3 R4

Chair(s) 황유철 (경희의대 내분비대사내과)
강지현 (건양의대 가정의학과)

18:30-19:00 Exploring the Extended Benefits of
Ipragliflozin Focusing on NAFLD
박정환 (한양의대 내분비대사내과)



Break

19:00-19:10 **Break**

Satellite Symposium 2

19:10-19:40 **Satellite Symposium 2**

Room1 R2 R3 R4

Chair(s) 박혜순 (울산의대 가정의학과)
한성호 (동아의대 가정의학과)

19:10-19:40 What to Consider When Treating T2DM Patients
with NAFLD
이은정 (성균관의대 내분비내과)



Day 2. 3월 18일 토요일

Breakfast Symposium 1, 2, 3

08:00-08:45 Breakfast Symposium 1		Room1 R2 R3 R4
Chair(s)	오승준 (경희의대 내분비대사내과)	
08:00-08:45	Impact of Cholesterol Lowering Treatment with Atorvastatin/Ezetimibe in High-risk CVD and CKD Patients 전성완 (순천향의대 내분비대사내과)	
08:00-08:45 Breakfast Symposium 2		R1 Room2 R3 R4
Chair(s)	김용성 (대자인병원 내분비내과)	
08:00-08:45	Rationales for DPP-4i+SGLT-2i Combination Therapy for Holistic T2D Management 조윤경 (울산의대 내분비내과)	
08:00-08:45 Breakfast Symposium 3		R1 R2 Room3 R4
Chair(s)	서영성 (계명의대 가정의학과)	
08:00-08:45	TG Lowering Treatment : Why & How? 김상용 (조선의대 내분비대사내과)	

Opening

		Room 1, 2, 3 R4
08:45-08:50 Opening		
08:45-08:50	개회사 김성수 (대한비만학회 회장)	

Symposium 1, 2, 3

08:50-10:20 Symposium 1: Treatment of Obesity

Room1 R2 R3 R4

Chair(s)
 우정택 (경희의대 내분비대사내과)
 이창범 (한양의대 내분비대사내과)

- 08:50-09:15 ABCs of Obesity Treatment
김경근 (가천의대 가정의학과)
- 09:15-09:40 Real World Evidence of Anti-Obesity Agents in Korea
임수 (서울의대 내분비내과)
- 09:40-10:05 Therapeutic Lifestyle Modification
for Obesity Management
박계영 (한양의대 가정의학과)
- 10:05-10:20 Panel Discussion
윤지완 (서울의대 내분비내과)
이경애 (전북의대 내분비내과)



08:50-10:20 Symposium 2: Integrative Physiology and Molecular Mechanisms of Obesity

R1 Room2 R3 R4

Chair(s)
 유순집 (가톨릭의대 내분비내과)
 김일영 (가천의대 의예과)

- 08:50-09:15 Astrocytic FoxO1 in the Hypothalamus Regulates
Energy Metabolism
김기우 (연세치대 구강생물학교실)
- 09:15-09:40 Lipid-Mediated Regulation of Adipocyte Metabolism
이윤희 (서울대 약대)
- 09:40-10:05 Multiparity Increases the Risk of Diabetes
by Impairing the Proliferative Ability of β cell
이준엽 (가톨릭의대 내분비내과)
- 10:05-10:20 Panel Discussion
이승환(가톨릭의대 내분비내과)
최영진(서울의대 해부학교실)



08:50-10:20 Symposium 3: Postprandial Glycemic Response and Continuous Glucose Monitoring		R1 R2 Room 3 R4
Chair(s)	김상용 (조선의대 내분비대사내과) 임정현 (서울대병원 급식영양과)	
08:50-09:15	Clinical Importance of Postprandial Glycemic Response revealed by CGM 문선준 (성균관의대 내분비내과)	
09:15-09:40	Research on Glycemic Variability of Meal by CGM 송윤주 (가톨릭대 식품영양학과)	
09:40-10:05	Application of the CGM in Obesity Management Program 홍명근 (서울대병원 건강증진센터)	
10:05-10:20	Panel Discussion 서성환 (성균관의대 내분비내과) 권미라 (서울대병원 급식영양과)	

Day 2. 3월 18일 토요일

Oral Presentation

08:50-09:40 **Oral Presentation 1**

R1 R2 R3 **Room 4**

Chair(s)
 권오빈 (서울의대 생화학교실)
 한병덕 (고려의대 가정의학과)

Judge(s)
 김진욱 (히포크라타의원)
 강서영 (울지의대 가정의학과)

08:50-09:00 Training Intensity Distribution Considering Energy System Contributions and Metabolic Flexibility between Different Individuals
 박소영 (차의대 스포츠의학대학원 운동생리학실)

09:00-09:10 Neuropeptide Y Neurons in Nucleus Accumbens Promote Palatable Food Memory
 천덕현 (서울의대 해부학교실)

09:10-09:20 Weight Cycling Accelerates Nonalcoholic Fatty Liver Disease (NAFLD) Progression through Activation of IGF1P7
 Shindy Soedono (순천향의대 의생명융합학과)

09:20-09:30 The Correlation between Skeletal Muscle Mass-Bone Mineral Density Index-cardiovascular Disease Risk Factors in Middle-aged and Young Adults
 김연휘 (피지컬랩)

09:30-09:40 Lifestyle Modification for Metabolic Syndrome as an Employee Assistant Program(EAP) at In-Company Clinic Setting
 박신애 (네이버 부속의원 가정의학과)

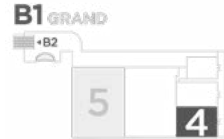

Break

10:20-10:30 **Break**

Symposium 4, 5, 6

10:30-12:00 **Symposium 4: Environmental, Genetics and Obesity** Room 1 R2 R3 R4

Chair(s) 강재현 (성균관의대 가정의학과)
김대중 (아주의대 내분비대사내과)

10:30-10:55 Endocrine Disrupting Chemicals as Metabolic Risk Factor
전숙 (경희의대 내분비내과)

10:55-11:20 Obesity Fact Sheet 2022
손장원 (가톨릭의대 내분비내과)

11:20-11:45 Treatment and Management of Obesity and Metabolic
Diseases Linked with Smartphone Applications
이상열 (경희의대 내분비내과)

11:45-12:00 Panel Discussion
양예슬 (서울의대 의학과)
서원운 (충남의대 가정의학과)



10:30-12:00 **Symposium 5: Gut Microbiome** R1 Room 2 R3 R4

Chair(s) 이문규 (을지의대 내분비대사내과)
김기우 (연세치대 구강생물학교실)

10:30-10:55 Host-microbe-nutrient interactions in human health:
Role of vitamin A transport in immunity
방예지 (서울의대 미생물학)

10:55-11:20 Interplay between Microbiome and Host Obesity
윤상선 (연세치대 미생물학교실)

11:20-11:45 The Human Microbiome and Cancer: Implications
for Clinical and Population Based Studies
안지영 (Population Health,
NYU Grossman School of Medicine, USA)

11:45-12:00 Panel Discussion
조윤정(대구가톨릭의대 가정의학과)
오범조(서울의대 가정의학과)



Symposium 4, 5, 6

10:30-12:00	Symposium 6: Digital Therapeutics in Obesity Management	R1 R2 Room 3 R4
Chair(s)	이관우 (아주의대 내분비대사내과) 이기영 (가천의대 내분비대사내과)	
10:30-10:55	Overview of Digital Therapeutics for the Management of Obesity 권혁태 (서울의대 가정의학과)	
10:55-11:20	Digital Healthcare 2023 나균호 (네이버 헬스케어 연구소)	
11:20-11:45	Digital Therapeutics for Management of Nonalcoholic Fatty Liver Disease 김주영 (㈜ 바이오뉴트리온)	
11:45-12:00	Panel Discussion 배재현 (고려의대 내분비내과) 남가은 (고려의대 가정의학과)	

Luncheon Lecture 1, 2

12:00-12:30	Luncheon Lecture 1	Room 1, 2, 3 R4
Chair(s)	김광원 (가천의대 내분비내과)	
12:00-12:30	The Way of the Most Effective Obesity Treatment with Phentermine Plus Topiramate ER 한병덕 (고려의대 가정의학과)	
12:30-13:00	Luncheon Lecture 2	
Chair(s)	김광원 (가천의대 내분비내과)	
12:30-13:00	SGLT2i as a New Mainstream of Treating T2D from Metabolism to Holistic Treatment 홍준화 (울지의대 내분비내과)	

Plenary Lecture

13:00-13:50 **Plenary Lecture**

Room 1, 2, 3

R4

Chair(s) 최영길 (경희의대 명예교수)

13:00-13:40 Obesity and Hypothalamic Innate Immune Responses to Fat-Rich Diets
김민선(울산의대 내분비내과)

13:40-13:50 Q&A

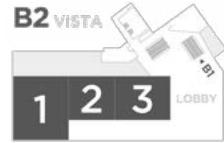

Break

13:50-14:00 **Break**

Symposium 7, 8, 9

14:00-15:30

Symposium 7: New Drug to Battle Obesity-related Diseases

Room 1

R2

R3

R4

Chair(s) 박태선 (전북의대 내분비대사내과)
임수 (서울의대 내분비내과)

14:00-14:25 Revisited; Amylin and GLP-1 as Anti-Obesity Drug Targets
전재한 (경북의대 내분비내과)

14:25-14:50 Cotadutide for the treatment of NASH
Arun J. Sanyal (Virginia Commonwealth University, USA)

14:50-15:15 Tirzepatide Once Weekly for the Treatment of Obesity
Carel Le Roux (University College Dublin, Ireland)

15:15-15:30 Panel Discussion
홍준화 (울지의대 내분비내과)
문준성 (영남의대 내분비내과)



Symposium 7, 8, 9

14:00-15:30 Symposium 8: Metabolic Surgery

R1 **Room 2** R3 R4

Chair(s)
 이상권 (가톨릭의대 외과)
 박정환 (한양의대 내분비대사내과)

14:00-14:25 A Change in ASMBS/IFSO Guideline: Indications for
 Metabolic and Bariatric Surgery
 이솔 (서울의료원 외과)

14:25-14:50 Long-term Effect of Bariatric & Metabolic Surgery in
 Low BMI Patients with Type 2 Diabetes Mellitus
 김상연 (순천향의대 외과)

14:50-15:15 Long-term Outcomes of Metabolic Surgery for T2DM
 with Non-morbid Obesity
 안수민 (연세의대 외과)

15:15-15:30 Panel Discussion
 정창희 (울산의대 내분비내과)
 한상문 (서울의료원 외과)



14:00-15:30 Symposium 9: Obesity Treatment in Adolescent

R1 R2 **Room 3** R4

Chair(s)
 김은미 (강북삼성병원 영양팀)
 홍용희 (순천향의대 소아청소년과)

14:00-14:25 Intervention for Children and Adolescents Who Are
 Severely Obese
 박경희 (한림의대 가정의학과)

14:25-14:50 Liraglutide for Weight Management in Children
 and Adolescents
 김화영 (서울의대 소아청소년과)

14:50-15:15 Syndromic Obesity & Treatment
 김유미 (충남의대 소아청소년과)

15:15-15:30 Panel Discussion
 안병덕 (고려의대 가정의학과)
 양아람 (성균관의대 소아청소년과)



Oral Presentation

14:00-14:50 **Oral Presentation 2**

R1 R2 R3 **Room 4**

Chair(s)	김성훈 (미즈메디병원 내분비내과) 김양현 (고려의대 가정의학과)
Judge(s)	이승환 (가톨릭의대 내분비내과) 류영상 (조선의대 내분비내과)
14:00-14:10	Chronic Physical Exercise Alleviates Stress-associated Neurobiological Activity in Obese Women: a Prospective 18F-FDG PET/CT Study 박기수 (고려의대 핵의학과)
14:10-14:20	Acute Effects of Foam Rolling Exercises on Arterial Stiffness, Flexibility and Autonomic Nervous System Function in Young and Middle-aged Women 이천옥 (인천대 체육학과)
14:20-14:30	Association between Body Mass Index and Mortality in Type 1 Diabetes: A Systematic Review and Meta-analysis 정한나 (한림의대 내분비내과)
14:30-14:40	Maternal Protein Restriction Disrupts Growth and Glucose Metabolism in Mouse Offspring, Reversed by Growth Hormone Treatment 김한빈 (서울의대 생화학교실)
14:40-14:50	Influence of GPER in AgRP Neurons in Diet-induced Obesity 박소희 (서울의대 생화학교실)

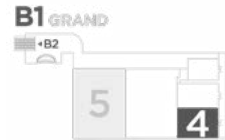

Break

15:30-15:40 **Break**

Day 2. 3월 18일 토요일

Keynote Lecture 1, 2

15:40-16:10 Keynote Lecture 1

Room1 R2 R3 R4

Chair(s) 이규래 (가천의대 가정의학과)

15:40-16:00 Does Obesity Promote Aging?: Physical Activity and the Role of Telomeres
신윤아 (단국대 스포츠학과)

16:00-16:10 Q&A



15:40-16:10 Keynote Lecture 2

R1 R2 Room3 R4

Chair(s) 이동환 (단국의대 소아청소년과)

15:40-16:00 Measures to Stay Healthy
정소정 (건국의대 소아청소년과)

16:00-16:10 Q&A



Symposium 10, 11, 12

16:10-17:40 Symposium 10: Comorbidity of Obesity

Room1 R2 R3 R4

Chair(s) 박철영 (성균관의대 내분비내과)
김선미 (고려의대 가정의학과)

16:10-16:35 Sleep Impact on Obesity
최명수 (울지의대 이비인후과)

16:35-17:00 Obesity and Cognition
최성혜 (인하의대 신경과)

17:00-17:25 Obesity and Cardiovascular Health
황유철 (경희의대 내분비대사내과)

17:25-17:40 Panel Discussion
이창현 (서울행복내과)
김진욱 (히포크라타의원)



Symposium 10, 11, 12

16:10-17:40 Symposium 11: Big Data in Obesity Research

R1 **Room 2** R3 R4

Chair(s) 김경수 (가톨릭의대 가정의학과)
김성래 (가톨릭의대 내분비내과)

16:10-16:35 Obesity and Cancer
한경도 (숭실대 정보통계보험수리학과)

16:35-17:00 The Obesity Paradox and Alternatives to BMI,
Weight-adjusted Waist Index (WWI)
김남훈 (고려의대 내분비내과)

17:00-17:25 Medical Big Data in Obesity Research
김헌성 (가톨릭의대 내분비내과)

17:25-17:40 Panel Discussion
구혜연 (서울의대 가정의학과)
류영상 (조선의대 내분비대사내과)



16:10-17:40 Symposium 12: Exercise, Obesity, and Metabolic Dysfunction

R1 R2 **Room 3** R4

Chair(s) 김기진 (계명대 체육학과)
김성수 (충남의대 가정의학과)

16:10-16:35 Role of Dietary Free Essential Amino Acids in
Endurance and Insulin Sensitivity during Resistance
Exercise Training: Beyond Muscle Hypertrophy
김일영 (가천의대 의예과)

16:35-17:00 The Effect of Exercise Type and Intensity
on Circulating Exerkines
이세원 (인천대 체육학부)

17:00-17:25 HIT your Brain: Neuron & New Run
이민철 (차의대 스포츠의학과)

17:25-17:40 Panel Discussion
김중희 (한양대 체육학과)
이정아 (경희대 체육대학원 스포츠의과학전공)



Award & Closing

Room 1, 2, 3 R4

17:40-18:00 Award & Closing

17:40-18:00 폐회사
박철영 (대한비만학회 이사장)





제 57차

대한비만학회
춘계학술대회

Rethinking Obesity as A Disease



제 57차

대한비만학회 춘계학술대회

Poster



PE01 Ezetimibe-induces vasodilation in rat mesenteric arteries through inhibition of extracellular Ca²⁺ influx

Eun Yi Oh¹, Chae Eun Haam¹, Sooyeon Choi¹, Seonhee Byeon¹, Soo-Kyoung Choi¹, Young-Ho Lee¹

¹Department of Physiology, Yonsei University College of Medicine, Republic of Korea

PE02 Improvement of hepatic steatosis and related factors after 6 month intervention in children with obesity: quantitative assessment of liver fat using MRI

Yoon Jeong Cho¹, Kyung Hee Par², Sarah Woo³

¹Department of Family Medicine, Daegu Catholic University School of Medicine, Republic of Korea

²Department of Family Medicine, Hallym University Sacred Heart Hospital, Hallym University College of Medicine, Republic of Korea

³Department of Medical Science, College of Medicine, Hallym University, Republic of Korea

PE03 The cardiovascular effects of long-chain omega-3 polyunsaturated fatty acid supplementation

Jae Hyun Bae¹, Hyunjung Lim², Soo Lim³

¹Department of Internal Medicine, Korea University Anam Hospital, Korea University College of Medicine, Republic of Korea

²Department of Medical Nutrition, Research Institute of Medical Nutrition, Graduate School of East-West Medical Science, Kyung Hee University, Republic of Korea

³Department of Internal Medicine, Seoul National University Bundang Hospital, Seoul National University College of Medicine, Republic of Korea

PE04 Gut-specific FXR agonist controls immune response in the crypt of the small intestine and stromal vascular fraction of visceral white adipose tissue.

Hyeonuk Jeon^{1,2,3}, Yoseob Lee^{1,2,3}, Sungsoon Fang^{1,4}, Dae-Keek Kim⁵, Jae-Woo Kim^{1,3}

¹Department of Biochemistry and Molecular Biology, Yonsei University College of Medicine, Republic of Korea

²Graduate School of Medical Science, Brain Korea 21 Project, Yonsei University College of Medicine, Republic of Korea

³Chronic Intractable Disease for Systems Medicine Research Center, Yonsei University College of Medicine, Republic of Korea

⁴Severance Biomedical Science Institute, Gangnam Severance Hospital, Yonsei University College of Medicine, Republic of Korea

⁵College of Pharmacy and Graduate School of Pharmaceutical Sciences, Ewha Womans University, Republic of Korea

PE05 Psychological and surgical treatment for body image enhances cognitive networks

Miwoo Lee^{1,2}, Sehoon Kim², Kyung Hwa Lee³, Hyung Jin Choi¹, Ho Lee¹

¹Department of biomedical science, Seoul National University College of Medicine, Republic of Korea

²Department of medicine, Seoul National University College of Medicine, Republic of Korea

³Division of Child and Adolescent Psychiatry, Department of Psychiatry, Seoul National University Hospital, Republic of Korea

PE06 Impact of Precautions Compliance on Body Composition Measurement by Segmental Bioelectrical Impedance Analysis

Chaeun Cho¹, Sewon Lee^{2,3,4}

¹Department of Human Movement Science, Graduate School, Incheon National University, Republic of Korea

²Division of Sport Science, College of Arts & Physical Education, Incheon National University, Republic of Korea

³Sport Science Institute, College of Arts & Physical Education, Incheon National University, Republic of Korea

⁴Health Promotion Center, College of Arts & Physical Education, Incheon National University, Republic of Korea

PE07 Effect of Virtual Reality Exercise Program Application In Type 2 Diabetes Patients

Jun-hwa Hong², Yu-jin Lee¹, Myung-haeng Hur¹

¹College of Nursing, University of Eulji, Republic of Korea

²Division of Endocrinology, Department of Internal Medicine, Daejeon Eulji Medical Center, Eulji University School of Medicine, Republic of Korea

PE08 Anthropometric changes in female participants in the combined aerobic and resistance training program longer than one year: A cohort study

Bumjo Oh¹, Hee-Jin Hwang², Han Jin Oh³

¹Department of Family Medicine, SMG-SNU Boramae Medical Center, Republic of Korea

²Department of Family Medicine, International St. Mary's Hospital, Catholic Kwandong University College of Medicine, Republic of Korea

³Department of Family Medicine, Eulji Medical Center, Eulji University, Republic of Korea

PE09 Effects of Cultural Acculturation on the risk of Overweight or Obesity and Changes in Diet Habits and Sleep Quality among Asian Foreign Students

Eugene Chang¹, Chunyang Wang², Hyejin Chun³, Miae Doo²

¹Department of Food and Nutrition, Gangneung-Wonju National University, Republic of Korea

²Department of Food and Nutrition, Kunsan National University, Republic of Korea

³Department of Family Medicine, Ewha Womans University College of Medicine, Republic of Korea

PE10 Development of Educational Materials of Healthy Lifestyle Practice for Adolescents and Elderly Citizens of Jinju City

Seolhyang Baek¹, Jiyong Park², Hyunmi Kim²

¹College of Nursing, Dongguk University WISE Campus, Republic of Korea

²College of Nursing, Inje University, Republic of Korea

PE11 Non-contact Multidisciplinary Intervention improves Dietary Factors of Children and Adolescents with Overweight and Obesity

Haelim Lee¹, Kumhee Son^{1,2}, YoonMyung Kim³, Kyung Hee Park⁴, Hyunjung Lim^{1,2}

¹Department of Medical Nutrition, Graduate School of East-West Medical Science, Kyung Hee University, Republic of Korea

²Research Institute of Medical Nutrition, Kyung Hee University, Republic of Korea

³University College, Yonsei University International Campus, Republic of Korea

⁴Department of Family Medicine, Hallym University Sacred Heart Hospital, Republic of Korea

PE12 The effects of isoflavones in overweight old adults with SHBG and glucose metabolism: Systematic review and Meta-analysis

Cho-Rong OH¹

¹Dept. of Food and Nutrition, Kyungsoong University, Republic of Korea

PE13 Validity of predictive equations for Resting Energy Expenditure in Korean obese adults

Jung-Eun Yim^{1,2}, Ji-Sook Park¹, Ha-Neul Choi¹, Hina Akbar²

¹Department of Food and Nutrition, Changwon National University, Republic of Korea

²Interdisciplinary Program in Senior Human Ecology, Changwon National University, Republic of Korea

PE14 20-30대 한국 성인의 비만 상태에 따른 영양소 섭취와 장내 미생물 군집 비교

황서연¹, 오다영¹, 나우리^{1,2}, 손정민^{1,2}

¹원광대학교 식품영양학과

²원광대학교 생명자원과학연구소

PE15 Microbiota mediates aerobic exercise capacity via modulation of skeletal muscle glucose metabolism

Hye Jin Kim^{1,2,4}, Youn Ju Kim^{1,2,3,4}, Dasomi Park^{1,2,3,4}, Sang Gyu Lee^{2,5}, Yong Jae Kim², Ji Hyeon Baek², Hak Su Kim², Il Yong Kim^{1,2}, Je Kyung Seong^{1,2,3,4,5}

¹Laboratory of Developmental Biology and Genomics, College of Veterinary Medicine, Seoul National University, Republic of Korea

²Korea Mouse Phenotyping Center (KMPC), Seoul National University, Republic of Korea

³BK21 Program for Veterinary Science, College of Veterinary Medicine, Seoul National University, Republic of Korea

⁴The Research Institute for Veterinary Science, College of Veterinary Medicine, Seoul National University, Republic of Korea

⁵Interdisciplinary Program for Bioinformatics, Program for Cancer Biology, BIO-MAX/N-Bio Institute, Seoul National University, Republic of Korea

PE16 Effect of calorie restriction and voluntary exercise on skeletal muscle morphology in high-fat diet-induced obesity

Fujue Ji^{1,2}, Hae Sung Lee^{1,2}, Jong-Hee Kim^{1,2}

¹Department of Physical Education, College of Performing Arts and Sport, Hanyang University, Republic of Korea

²BK21 FOUR Human-Tech Convergence Program, Hanyang University, Republic of Korea

PE17 Positive and negative food primes, self-weighing, and the prevention of age-related weight gain

David A. Levitsky^{1,2}, Daehong Kim¹, Alyse Mizia¹, Jonathan Jung Hun Kim¹, Laura Barre¹, Yingyi Zhong¹

¹ Division of Nutritional Sciences, Cornell University, Ithaca, New York, USA

² Department of Psychology, Cornell University, Ithaca, New York, USA

PE18 Waist circumference and risk of Parkinson's disease

Kye-Yeung Park¹, Ga Eun Nam², Kyungdo Han³, Hoon-Ki Park¹, Hwan-Sik Hwang¹

¹ Department of Family Medicine, Hanyang University College of Medicine, Republic of Korea

² Department of Family Medicine, Korea University College of Medicine, Republic of Korea

³ Department of Statistics and Actuarial Science, Soongsil University, Republic of Korea

PE19 Comparison of anthropometric indices for predicting metabolic syndrome in Korean adults

SeokHong Lee¹

¹ Internal medicine, Mirang Yoon Hospital, Republic of Korea

PE20 Fatty Liver and Risk of Head and Neck Cancer in Diabetes Mellitus: A Nationwide Cohort Study

Junhee Park¹, Kyungdo Han², Seung Woo Lee³, Yeong Jeong Jeon⁴, Sang-Man Jin⁵, Wonyoung Jung¹, Yoon Kyoung So⁶, Sang Duk Hong⁷, Dong Wook Shin^{1,8}

¹ Department of Family Medicine/Supportive Care Center, Samsung Medical Center, Sungkyunkwan University School of Medicine, Republic of Korea

² Department of Statistics and Actuarial Science, Soongsil University, Republic of Korea

³ Department of Biostatistics, College of Medicine, Catholic University of Korea, Republic of Korea

⁴ Department of Thoracic and Cardiovascular Surgery, Samsung Medical Center, Sungkyunkwan University School of Medicine, Republic of Korea

⁵ Department of Endocrinology and Metabolism, Samsung Medical Center, Sungkyunkwan University School of Medicine, Republic of Korea

⁶ Department of Otorhinolaryngology-Head & Neck Surgery, Ilsan Paik Hospital, Inje University College of Medicine, Republic of Korea

⁷ Department of Otolaryngology, Head and Neck Surgery, Samsung Medical Center, Sungkyunkwan University School of Medicine, Republic of Korea

⁸ Department of Clinical Research Design and Evaluation, Samsung Advanced Institute for Health Science and Technology, Sungkyunkwan University, Republic of Korea

PE21 Gender differences in the risk of incident NAFLD according to the transition of abdominal obesity status: a 16-year cohort study

Jun-Hyuk Lee^{1,2}, Soyoung Jeon³, Min-Young Do⁴, Hye Sun Lee³, Yu-Jin Kwon⁵

¹Department of Family Medicine, Nowon Eulji Medical Center, Eulji University School of Medicine, Republic of Korea

²Department of Medicine, Hanyang University Graduate School of Medicine, Republic of Korea, Gangnam Severance Hospital, Yonsei University College of Medicine, Republic of Korea

³Biostatistics Collaboration Unit, Department of Research Affairs, Yonsei University College of Medicine, Republic of Korea

⁴Division of Gastroenterology, Department of Internal Medicine, Gangnam Severance Hospital, Yonsei University College of Medicine, Republic of Korea

⁵Department of Family Medicine, Yongin Severance Hospital, Yonsei University College of Medicine, Republic of Korea

PE22 Different patterns of associations between body mass index and the risks for type 2 diabetes, hypertension, and dyslipidemia in Korean men and women

Seo Young Kang¹, Ye-Jee Kim², Hye Soon Park³

¹Department of Family Medicine, Uijeongbu Eulji Medical Center, Eulji University College of Medicine, Republic of Korea

²Department of Clinical Epidemiology and Biostatistics, Asan Medical Center, Republic of Korea

³Department of Family Medicine, Asan Medical Center, University of Ulsan College of Medicine, Republic of Korea

PE23 Sleep quality in women with premenstrual syndrome is associated with metabolic syndrome-related variables.

Miae Doo¹, Saebom Park¹, Eugene Chang², Hyejin Chun³

¹Department of Food and Nutrition, Kunsan National University, Republic of Korea

²Department of Food and Nutrition, Gangneung-Wonju National University, Republic of Korea

³Department of Family Medicine, Ewha Womans University College of Medicine, Republic of Korea

PE24 Measurement of Waist Circumference at Different Sites Affects the Identification of Clustering of Cardiometabolic Risk Factors in Korean Adults

Ye Jin Kim¹, So Jung Lee², Kyung Hee Park³

¹Physical Education, Graduate School, Kyung Hee University, Republic of Korea

²Division of Sports Medicine, Graduate School of Physical Education, Kyung Hee University, Republic of Korea

³Department of Family Medicine, Hallym University Sacred Heart Hospital, Republic of Korea

PE25 Exploring Diverse Distributions of Body Mass Index and Waist Circumference among Adults: A Bi-national Study Examining Racial, Ethnic, and Sex Differences in South Korea and the United States

Seounghyun Eum¹, Chanyang Min², Wonyoung Cho², Sunyoung Kim³, Ho Geol Woo⁴, Dong Keon Yon^{2,5}, and Sang Youl Rhee^{2,6}

¹Department of Medicine, Kyung Hee University College of Medicine, Republic of Korea

²Center for Digital Health, Medical Science Research Institute, Kyung Hee University Medical Center, Kyung Hee University College of Medicine, Republic of Korea

³Department of Family Medicine, Kyung Hee University College of Medicine, Republic of Korea

⁴Department of Neurology, Kyung Hee University College of Medicine, Republic of Korea

⁵Department of Pediatrics, Kyung Hee University College of Medicine, Republic of Korea

⁶Department of Endocrinology and Metabolism, Kyung Hee University College of Medicine, Republic of Korea

PE26 Introducing the 'Weight Management Health Note' application designed by the Korean Society for the Study of Obesity (KSSO)

Sang Youl Rhee^{1,3,5}, Sunyoung Kim^{1,2,3}, Doo Ah Choi^{1,4}

¹Committee of IT-convergence Treatment of Metabolic Syndrome, the Korean Society for the Study of Obesity

²Department of Family Medicine, College of Medicine, Kyung Hee University, Republic of Korea

³Center for Digital Health, Medical Science Research Institute, Kyung Hee University Medical Center, Republic of Korea

⁴Hurray Positive, Inc., Republic of Korea

⁵Department of Endocrinology and Metabolism, College of Medicine, Kyung Hee University, Republic of Korea

PE27 Associations of Obesity and Central Obesity with Risk of Prostate Cancer in Young Adults Men: A National Population-Based Observational Study

Jin-Hyung Jung¹, Kyung-Do Han²

¹Samsung Biomedical Research Institute, Sungkyunkwan University School of Medicine, Suwon, Republic of Korea

²Department of Statistics and Actuarial Science, Soongsil University, Seoul, Republic of Korea

PE28 Control of hypothalamic SMP30 ameliorate metabolic disorders in high fat diet-induced obesity

Min Soo Kim¹, Ji Yun Van^{1,2}, MinJun Jang¹, Bonggi Lee²

¹Brain Science Institute, Korea Institute Science and Technology (KIST), Republic of Korea

²Department of Food & Nutrition, Pukyong National University, Republic of Korea

PE29 Role of Lateral Hypothalamus GABAergic Neurons on Goal-directed Behaviors in Non-human Primates

Jae Sun Ha¹, Inhyeok Baek¹, Young Hee Lee¹, Jisun Min¹, Yunkyo Jung¹, Miwoo Lee¹, Kyung Seob Lim⁴, Chang-Yeop Jeon², Junghyung Park², Jinyoung Won², Hyeon-Gu Yeo^{2,3}, Keonwoo Kim^{2,5}, Yu Gyeong Kim^{2,3}, Won Seok Choi², Sung-hyun Park², Youngjeon Lee², Hyung Jin Choi¹

¹Department of Biomedical Sciences, Seoul National University College of Medicine, Republic of Korea

²National Primate Research Center, Korea Research Institute of Bioscience and Biotechnology (KRIBB), Republic of Korea

³KRIBB School of Bioscience, Korea University of Science and Technology, Republic of Korea

⁴Futuristic Animal Resource & Research Center, KRIBB, Republic of Korea

⁵School of Life Sciences, BK21 Plus KNU Creative BioResearch Group, Kyungpook National University, Republic of Korea

Poster

PE30 Efficacy of information and communication technology interventions for the management of diabetes mellitus: an umbrella review and evidence map

Hyeri Lee², Sangil Park¹, Wonyoung Cho², Woo Ho Geol¹, Hyunjung Lim³, Sunyoung Kim⁴, Sang Youl Rhee^{2,5}, Dong Keon Yon^{2,6}

¹Department of Neurology, Kyung Hee University Medical Center, Kyung Hee University College of Medicine, Republic of Korea

²Center for Digital Health, Medical Science Research Institute, Kyung Hee University Medical Center, Kyung Hee University College of Medicine, Republic of Korea

³Department of Medical Nutrition, Graduate School of East-West Medical Science, Kyung Hee University, Republic of Korea

⁴Department of Family Medicine, Kyung Hee University Medical Center, Kyung Hee University College of Medicine, Republic of Korea

⁵Department of Endocrinology and Metabolism, Kyung Hee University College of Medicine, Republic of Korea

⁶Department of Pediatrics, Kyung Hee University College of Medicine, Republic of Korea

PE31 National and regional trends in the prevalence of type 2 diabetes and associated risk factors among Korean adults before and during the COVID-19 pandemic, 2009 to 2021: a representative long-term serial study

Soeun Kim^{2,3}, Jiyeon Oh¹, Sang Youl Rhee^{2,4}, Min Seo Kim⁵, Ju-Young Shin⁶, Hyunjung Lim⁷, Sunyoung Kim⁸, Seung Won Lee⁹, Dong Keon Yon^{2,10}

¹Department of Medicine, Kyung Hee University College of Medicine, Republic of Korea

²Center for Digital Health, Medical Science Research Institute, Kyung Hee University College of Medicine, Republic of Korea

³Department of Regulatory Science, Kyung Hee University, Republic of Korea

⁴Department of Endocrinology and Metabolism, Kyung Hee University School of Medicine, Republic of Korea

⁵Medical and Population Genetics and Cardiovascular Disease Initiative, Broad Institute of MIT and Harvard, Cambridge, MA, USA

⁶School of Pharmacy, Sungkyunkwan University, Republic of Korea

⁷Department of Medical Nutrition, Graduate School of East-West Medical Science, Kyung Hee University, Republic of Korea

⁸Department of Family Medicine, Kyung Hee University Medical Center, Kyung Hee University College of Medicine, Republic of Korea

⁹Department of Precision Medicine, Sungkyunkwan University School of Medicine, Republic of Korea

¹⁰Department of Pediatrics, Kyung Hee University Medical Center, Kyung Hee University College of Medicine, Republic of Korea

PE32 Discrepancies between diabetes and body mass index and waist circumference

Taesic Lee¹, Jong-Koo Kim¹

¹Department of Family Medicine, Yonsei University Wonju College of Medicine, Republic of Korea

- PE33** Association between piezo1 channel and vascular dysfunction of type 2 diabetic mice
Chae Eun Ham¹, Sooyeon Choi¹, Eun Yi Oh¹, Seonhee Byeon¹, Soo-Kyoung Choi¹, Young-Ho Lee¹
¹*Department of Physiology, Yonsei University College of Medicine, Republic of Korea*
-
- PE34** The vasodilatory effect of dapagliflozin in rat coronary arteries is mediated by inhibition of extracellular Ca²⁺ influx
Sooyeon Choi¹, Chae Eun Haam¹, Eun Yi Oh¹, Seonhee Byeon¹, Soo-Kyoung Choi¹, Young-Ho Lee¹
¹*Department of Physiology, Yonsei University College of Medicine, Republic of Korea*
-
- PE35** Effects of social distancing due to covid-19 on lifestyle and health status of patients with dyslipidemia
Jihyun Yoon¹, Bo-Hyun Kim¹, Rapha Kim¹, Yeon-Kyung Ahn¹, Bori Park¹, Daeun Oh¹, Yang Hyun Kim¹, Byoungduck Han¹
¹*Department of Family Medicine, Korea University College of Medicine, Seoul, Republic of Korea*
-
- PE36** Prevalence of hypertriglyceridemia in Korean adults and related factors: A nationwide study in Korea
Kye-Young Park¹, Sangmo Hong², Kyung-Soo Kim³, Kyungdo Han⁴ and Cheol-Young Park⁵
¹*Department of Family Medicine, Hanyang University College of Medicine, Republic of Korea*
²*Department of Internal Medicine, Hanyang University Guri Hospital, Hanyang University College of Medicine, Republic of Korea*
³*Department of Internal Medicine, CHA Bundang Medical Center, CHA University School of Medicine, Republic of Korea*
⁴*Department of Statistics and Actuarial Science, Soongsil University, Republic of Korea*
⁵*Department of Internal Medicine, Kangbuk Samsung Hospital, Sungkyunkwan University School of Medicine, Republic of Korea*
-
- PE37** Relationship between dyslipidemia and Serum Uric Acid levels in Korean Adults
Bo-Hyun Kim¹, Jihyun Yoon¹, Yeon-Kyung Ahn¹, Bori Park¹, Rapha Kim¹, Dae un Oh¹, Yang Hyun Kim¹, Byoungduck Han¹
¹*Department of Family Medicine, Korea University College of Medicine, Republic of Korea*
-
- PE38** Fermented soy sauce provides anti-obesity effects in high-fat diet induced obese rats, regardless of its high salt concentration
Chan-Ho Park¹, Eun-Ji Lee¹, Jeong-Woo Song¹, Eun-Gyung Mun¹, Jinxi Wang¹, Anna Han^{1,2}, Youn-Soo Cha^{1,2}
¹*Department of Food Science and Human Nutrition, Jeonbuk National University, Republic of Korea*
²*K-Food Research Center, Jeonbuk National University, Republic of Korea*

Poster

PE39 Gochujang has anti-obesity effects via capsaicin-independent brown adipose tissue activation and thermogenesis in high-fat diet induced obese mice

Jeong-Woo Song¹, Hyunwook Lee¹, Soonkyu Chung², Anna Han^{1,3}, Youn-soo Cha^{1,3}

¹Department of Food Science and Human Nutrition, Jeonbuk National University, Republic of Korea

²K-Food Research Center, Jeonbuk National University, Republic of Korea

PE40 Gochujang improves a high-fat diet-induced liver inflammation by refining gut microbiota dysbiosis

Eun-Bi Seo¹, Eun-Ji Lee¹, Olivet Chiamaka Edward¹, Eun-Gyung Mun¹, Anna Han^{1,2}, Youn-Soo Cha^{1,2}

¹Department of Food Science and Human Nutrition, Jeonbuk National University, Republic of Korea

²K-Food Research Center, Jeonbuk National University, Republic of Korea

PE41 High-fat diet stimulated the loading of PLOD1 into exosomes in adipose tissue

Ok-Kyung Kim¹, Juhwan Lee¹

¹Department of Food and Nutrition, Chonnam National University, Republic of Korea

PE42 Assessment of Cardiac Autonomic Function and CVD risk in Patients with Diabetes at risk for Metabolic Syndrome

Chun-Ja Kim¹, Hee-Sun Kang², Moonsun Kim¹, Ga-Young Lee¹, Jung-Suk Kim³, Dae-Jung Kim⁴

¹Department of Nursing, Ajou University College of Nursing, Republic of Korea

²Red Cross College of Nursing, Chung-Ang University, Republic of Korea

³Department of Nursing, Hye-Jeon College, Republic of Korea

⁴Department of Endocrinology & Metabolism, Ajou University School of Medicine, Republic of Korea

PE43 Association between Obesity and the Risk of Moyamoya Disease

Joonub Lee¹, Seung-Hwan Lee¹, Hyuk-Sang Kwon², Mee-Kyoung Kim², Jae-Seung Yun³, Kun-Ho Yoon¹, Jae-Hyoung Cho¹, Kyungdo Han⁴, Jang Won Son⁵

¹Division of Endocrinology and Metabolism, Department of Internal Medicine, Seoul St. Mary's Hospital, College of Medicine, The Catholic University of Korea, Seoul, Korea

²Division of Endocrinology and Metabolism, Department of Internal Medicine, Yeouido St. Mary's Hospital, College of Medicine, The Catholic University of Korea, Seoul, Korea

³Division of Endocrinology and Metabolism, Department of Internal Medicine, St. Vincent's Hospital, College of Medicine, The Catholic University of Korea, Seoul, South Korea

⁴Department of Statistics and Actuarial Science, Soongsil University, Seoul, Korea

⁵Division of Endocrinology and Metabolism, Department of Internal Medicine, Bucheon St. Mary's Hospital, College of Medicine, The Catholic University of Korea, Seoul, Korea

- PE44** DGAT2 is a key regulator of mitochondrial dysfunction in hepatocellular carcinoma
Yoseob Lee^{1,2,3}, Nahee Hwang^{1,2,3}, Kyu-Hye Chun^{1,2,3}, Jae-Won Kim^{1,2,3}, Hyeonuk Jeon^{1,2,3}, Bo Kyung Yoon^{1,3}, Tae Hyun Kim^{1,3}, Mi-Young Kim^{1,3}, Sungsoon Fang^{1,4}, Jae-Woo Kim^{1,3}
¹Department of Biochemistry and Molecular Biology, Yonsei University College of Medicine, Republic of Korea
²Graduate School of Medical Science, Brain Korea 21 Project, Yonsei University College of Medicine, Republic of Korea
³Chronic Intractable Disease for Systems Medicine Research Center, Yonsei University College of Medicine, Republic of Korea
⁴Severance Biomedical Science Institute, Gangnam Severance Hospital, Yonsei University College of Medicine, Republic of Korea
-
- PE45** Association between depression and non-alcoholic fatty liver disease according to obese status: The Korean National Health and Nutrition Examination Survey 2010-2019
Young Sang Lyu¹, Jin Hwa Kim¹, Sang Yong Kim¹
¹Department of Endocrinology and Metabolism, Chosun University Hospital, Republic of Korea
-
- PE46** Regional brain volume changes in obese nuns
Se-Hong Kim², Ju-Hye Chung¹, Bo-Kyung Kim²
¹Department of Family Medicine, Yeouido St. Mary's Hospital, College of Medicine, The Catholic University of Korea, Republic of Korea
²Department of Family Medicine, St. Vincent's Hospital, College of Medicine, The Catholic University of Korea, Republic of Korea
-
- PE47** Primary cilia regulate adaptive responses to fasting
Dong Joo Yang¹, Le Trung Tran¹, Doan V Khanh¹, Seul Ki Kim¹, Chan Yang Ju¹, Ha Thi Anh Thu¹, Mai Dang Thi¹, Dae Yeon Lee¹, Dong Min Shin¹, Yun-Hee Choi¹, Ki Woo Kim¹
¹Division of Physiology, Departments of Applied Life Science and Oral Biology, Yonsei University College of Dentistry, Republic of Korea
-
- PE48** Clinical predictors for the Efficacy of SGLT-2 Inhibitors Versus GLP-1 Receptor Agonists on Major Adverse Cardiovascular Events: A Meta-analysis Study
Minji Sohn¹, Johannes W. Dietrich², Michael A. Nauck², Soo Lim¹
¹Department of Internal Medicine, Seoul National University Bundang Hospital, Seoul National University College of Medicine, Seongnam, Republic of Korea
²Diabetes, Endocrinology and Metabolism Section, Department of Medicine I, St. Josef Hospital, Catholic Hospitals Bochum, Ruhr University Bochum, Bochum, Germany
-
- PE49** Antipsychotics-induced POMC neuron disorders is ameliorated by metformin administration
Saeha Kim¹, Sang Bum Suh², Jaedeok Kim¹, Nayoung Lee¹, Sooyeon Jang¹, Seonjae Oh¹, Subin Moon¹, Chan Hee Lee^{1,3}
¹Department of Biomedical Science, Hallym University, Republic of Korea
²Department of Internal Medicine, Asan Medical Center, Republic of Korea
³Program of Material Science for Medicine and Pharmaceuticals, Hallym University, Republic of Korea

- PE50** Hypothalamic microgliosis contributes to olanzapine-induced metabolic side effects
Soo Yeon Jang¹, Jae Deok Kim¹, Na Young Lee¹, Sang Bum Suh¹, Sae Ha Kim¹, Su Bin Moon¹, Seon Jae Oh¹, Chan Hee Lee^{1,3}
¹Department of Biomedical Science, Hallym University, Republic of Korea
²Department of Internal Medicine, Asan Medical Center, Republic of Korea
³Program of Material Science for Medicine and Pharmaceutics, Hallym University, Republic of Korea
-
- PE51** 12-OAHS is a Component of Olive Oil and Mitigates Obesity-induced Inflammation
Shindy Soedono¹, Vo Hoang Nguyet Dan¹, Yuha Joo, Maria Averia², Kae Won Cho^{1,2}
¹Department of Integrated Biomedical Science, Soonchunhyang University, Republic of Korea
²Soonchunhyang Institute of Medi-Bio Science (SIMS), Soonchunhyang University, Republic of Korea
-
- PE52** Preserved Muscle Strength Despite Muscle Mass Loss after Bariatric Surgery: A Systematic Review and Meta-analysis
Han Na Jung¹, Seon-Ok Kim², Chang Hee Jung^{3,4}, Woo Je Lee^{3,4}, Joong-Yeol Park^{3,4}, Yun Kyung Cho^{3,4}
¹Department of Internal Medicine, Hallym University Sacred Heart Hospital, Hallym University College of Medicine, Republic of Korea
²Department of Biostatistics and Clinical Epidemiology, Asan Medical Center, University of Ulsan College of Medicine, Republic of Korea
³Asan Diabetes Center, Asan Medical Center, Republic of Korea
⁴Department of Internal Medicine, Asan Medical Center, University of Ulsan College of Medicine, Republic of Korea
-
- PE53** Relationship between sleep duration and metabolic health in adolescents
Kayoung Lee¹
¹Department of Family Medicine, Inje University Busan Paik Hospital, Korea
-
- PE54** Prediction model that factors related to Body Mass Index(BMI) of adolescents in the era of COVID-19
Myeung Hee Han¹
¹School of Nursing, Dongyang University, Republic of Korea
-
- PE55** Trends in serum uric acid levels in Korean children and adolescents between 2016 and 2020: a nationwide study
Yu-Jin Kwon³, Ehn-Young Kim¹, Hye-Won Lee², Ji-Won Lee¹, Nak-Hoon Son²
¹Department of Family Medicine, Severance Hospital, Yonsei University College of Medicine, Republic of Korea
²Department of Statistics, Keimyung University, Republic of Korea
³Department of Family Medicine, Yongin Severance Hospital, Yonsei University College of Medicine, Republic of Korea
-
- PE56** Associations between obesity and clustering of cardiovascular comorbidities among Korean adolescents
Youn Huh¹, Hye Soon Park²
¹Department of Family Medicine, Uijeongbu Eulji Medical Center, Eulji University, Republic of Korea
²Department of Family Medicine, Asan Medical Center, University of Ulsan College of Medicine, Republic of Korea

PE57 Lifestyle-related stroke risk factors in obesity

Hyo Jin Park¹, Ga Eun Nam¹

¹Department of Family Medicine, Korea University Guro Hospital, Korea University College of Medicine, Seoul, Republic of Korea

PE58 The glyceic role of leptin and ghrelin after treatment of SGLT2 inhibitors in type 2 diabetes

김성연¹, 성가연¹, 홍준화¹

¹대전 을지대학교병원, 내분비내과

PE59 Lateral Hypothalamic Leptin Receptor Neurons Drive Hunger-gated Food-seeking and Consummatory Behaviours

Young Hee Lee¹, You Bin Kim¹, Kyu Sik Kim¹, Mirae Jang^{1,2}, Ha Young Song¹, Sang-Ho Jung¹, Dong-Soo Ha¹, Joon Seok Park¹, Jaegeon Lee^{1,5}, Kyung Min Kim¹, Deok-Hyeon Cheon¹, Inhyeok Baek¹, Min-Gi Shin⁶, Eun Jeong Lee⁶, Sang Jeong Kim^{1,2,4,5}, and Hyung Jin Choi^{1,3,4,5}

¹Department of Biomedical Sciences, Seoul National University College of Medicine, Republic of Korea

²Department of Physiology, Seoul National University College of Medicine, Republic of Korea

³Department of Anatomy and Cell Biology, Seoul National University College of Medicine, Republic of Korea

⁴Neuroscience Research Institute, Seoul National University College of Medicine, Republic of Korea

⁵Wide River Institute of Immunology, Seoul National University, Republic of Korea

⁶Department of Brain Science, Ajou University School of Medicine, Republic of Korea

PE60 Association between body mass index and survival after hematopoietic stem cell transplantation

Hansang Baek¹, Jong Hyuk Lee², Joonyub Lee¹, Yoo-Jin Kim², Jae-Ho Yoon², Seung-Hwan Lee^{1,3}

¹Division of Endocrinology and Metabolism, Department of Internal Medicine, Seoul St. Mary's Hospital, College of Medicine, The Catholic University of Korea, Republic of Korea

²Department of Hematology, Catholic Hematology Hospital, Seoul St. Mary's Hospital, College of Medicine, The Catholic University of Korea, Republic of Korea

³Department of Medical Informatics, College of Medicine, The Catholic University of Korea, Republic of Korea

PE61 The effects of micronutrient supplementation on depressive symptoms in obese individuals

Patrick Melcher¹

¹Faculty of Psychology, Maastricht University, Netherlands



제 57차

대한비만학회
춘계학술대회

Rethinking Obesity as A Disease

제 57차

대한비만학회 춘계학술대회

참가안내



참가안내

학술대회 개요

- 대회명: 제57차 대한비만학회 춘계학술대회
- 일정: 2023년 3월 17일(금) ~ 18일(토)
- 장소: 그랜드 워커히 서울
- 주최: 대한비만학회(KOREAN SOCIETY FOR THE STUDY OF OBESITY)
- 공식 홈페이지: kossoasc.org

공식 행사

Welcome Reception

- 일시: 3월 17일(금), 19:40 ~
- 장소: ROOM 3 (비스타홀 3)

Opening

- 일시: 3월 18일(토), 08:45 ~ 08:50
- 장소: ROOM 1,2,3 (비스타홀 1,2,3)

Award & Closing

- 일시: 3월 18일(토), 17:40 ~ 18:00
- 장소: ROOM 1 (비스타홀 1)

운영 안내

등록데스크

- 일시: 3월 17일(금) 14:00 ~ 20:00 / 3월 18일(토) 07:30 ~ 18:00
- 장소: 비스타홀 로비 (B2)

명찰

대회장 내에서 항상 착용하여 주시기 바랍니다.

프로그램북 & 초록집

행사 홈페이지(kossoasc.org)에서 PDF 파일을 다운로드 가능합니다.

영수증 & 참가확인증

홈페이지 마이페이지에서 확인 및 출력이 가능합니다.
참가확인증은 학회 종료 후 확인 및 출력이 가능합니다.

프리뷰룸

- 일시: 3월 17일(금) 15:00 ~ 20:00 / 3월 18일(토) 07:00 ~ 17:00
- 장소: 아이다홀 2 (B1)

발표자료 확인

세션 시작 1시간 전, 연자 및 구연 발표자는 프리뷰룸에 반드시 방문하여 필요 서류 작성 및 최종 발표자료를 확인하여 주십시오.

포스터 전시

- 일시: 3월 18일(토) 08:00 ~ 16:00
- 장소: ROOM 5 (그랜드홀 2,3)

우수 포스터 전시

- 일시: 3월 18일(토) 08:00 ~ 16:00
- 장소: 비스타홀 통로 (B2)

최우수 포스터 투표

가장 우수하다고 생각하는 포스터에 스티커를 붙여 투표해 주십시오.
포스터 전시 종료 후 집계하여 수상자 선정에 반영됩니다.

참가안내

운영 안내

부스 전시

- 3월 18일(토) 08:00 ~ 18:00, 비스타홀 로비 (B2)
- 3월 18일(토) 08:00 ~ 16:00, ROOM 5 (그랜드홀 2,3)

기념품 & 경품 데스크

- 일시: 3월 18일(토) 08:00 ~ 16:00
- 장소: 아이다홀 로비 (B1)

운영사무국

- 일시: 3월 17일(금) 15:00 ~ 20:00 / 3월 18일(토) 07:00 ~ 18:00
- 장소: 비스타홀 클락룸 (B2)

물품 & 분실물 보관

사무국에 방문하시어 문의 바랍니다.

식사

Satellite Symposium 1-2

- 일시: 3월 17일(금) 18:30 ~ 19:40
- 장소: ROOM 1 (비스타홀 1)

Breakfast Symposium 1-3

- 일시: 3월 18일(토) 08:00 ~ 08:45
- 장소: ROOM 1,2,3 (비스타홀 1,2,3)

Luncheon Lecture 1-2

- 일시: 3월 18일(토) 12:00 ~ 13:00
- 장소: ROOM 1 (비스타홀 1)

*Room 2와 Room 3에서도 중계화면으로 강의를 시청하며 식사를 하실 수 있습니다.

평점 안내

제공 평점

구분	3월 17일(금)	3월 18일(토)
대한의사협회	최대 1평점	최대 6평점
내과전공의 외부학술회의(학술대회)	없음	최대 2평점 *오전, 오후 각 1점으로 산정
대한비만학회(비만전문인정의) *별도 신청 없음.	최대 1평점	최대 6평점
한국영양교육평가원 임상영양사 전문연수교육(CPD)	없음	5평점
대한운동사협회	없음	25평점

이수 시간에 따른 부분 평점 및 주의사항 안내

시스템 기록에 따른 이수 시간	3월 18일(토)
1시간 미만	없음
1시간 이상 ~ 2시간 미만	1평점
2시간 이상 ~ 3시간 미만	2평점
3시간 이상 ~ 4시간 미만	3평점
4시간 이상 ~ 5시간 미만	4평점
5시간 이상 ~ 6시간 미만	5평점
6시간 이상	6평점 (최대)

- 이수 시간은 행사장에 설치된 '입출결 확인 시스템'으로 기록됩니다.
- 입실 시와 퇴실 시 1일 2회 명찰의 바코드를 입출결 확인 시스템에 태깅하여 주십시오.
- 입/퇴실 시 바코드를 태깅하지 않은 경우 이수 시간이 인정되지 않습니다.
- 휴게 시간은 이수 시간에 포함되지 않습니다.
- 이수 시간은 학술대회 시작 시간부터 종료 시간 내에서만 인정됩니다.
- 학술대회 종료 후, 학회 사무국에서 취합된 명단을 의사협회 연수 교육 시스템에 등록하여 자동으로 평점이 부여됩니다(약 4주 소요). 개인에게 평점카드를 발급하지 않습니다.

참가안내

이벤트

스탬프 투어

EVENT 1

브론즈 / 포스터존 11개 부스의 스탬프를 날인 후
기념품 교환 데스크를 방문하시면 기념품을 증정드립니다.

- 교환 시간 : 2023년 3월 18일(토) 08:00 ~ 16:00
- 교환 장소 : 기념품 수령 데스크 (아이다홀 로비, B1)



경품 이벤트

EVENT 2

필수 방문 부스(브론즈 / 포스터존) 11개를 포함하여
총 20개 이상 스탬프 날인 후 경품 응모 데스크를 방문하시면 경품 응모권을 드립니다.

- 응모 일시 : 2023년 3월 18일(토), 08:00 ~ 16:00
- 응모 장소 : IDA Hall 로비 (B1)
- 추첨 일시 : 2023년 3월 18일(토) 17:40~18:00, Closing & Award, 폐회식
- 추첨 장소 : ROOM 1 (비스타홀 1, B2)

<p>1등</p>  <p>맥북 에어 M1</p>	<p>2등</p>  <p>다이슨 에어랩</p>	<p>3등</p>  <p>네스프레소 커피머신</p>	<p>4등</p>  <p>갤럭시 워치4</p>	<p>5등</p>  <p>갤럭시 버즈2</p>
---	--	---	--	--

- 준비된 수량이 소진될 시에 조기 종료될 수 있습니다.
- 중복 응모 불가합니다.



제 57차
대한비만학회 춘계학술대회

후원/전시



후원/전시

부스 배치도 (B2)



No.	참여자	No.	참여자	No.	참여자
1,2	알보젠 코리아	35,36	종근당	22	오가는
11,12	노보노디스크	3,4	GC녹십자	30	보령제약
7,8	한미약품	5,6	셀트리온제약	37	렐리
13,14	유한양행	9,10	LG화학	38	BILLY
15,16	대웅제약	23,24	사노피	39	아주약품
18,19	HK이노엔	28,29	아스트라제네카	40	증외제약
26,27	한독	17	다이이피산교	41	셀바스헬스케어
31,32	동아ST	20	다림바이오텍	25	JOMES
33,34	MSD	21	대원제약		

부스 배치도 (B1)

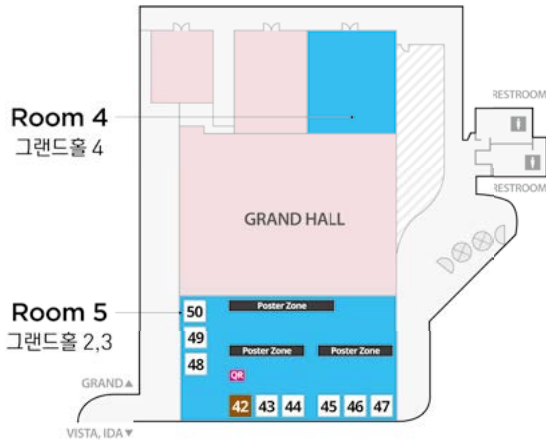

No.	참여자
42	광동제약
43	노바티스
44	비아트리스
45	국제약품
46	제일약품
47	인바디
48	엘피지오
49	이오플로우
50	넥스팜코리아

후원/전시

후원사

다이아몬드



플래티넘



골드



실버



브론즈

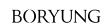

제 57차

대한비만학회
춘계학술대회

Rethinking Obesity as A Disease



제 57차
대한비만학회 춘계학술대회
Rethinking Obesity as A Disease

대한비만학회

CONTACT NUMBER 02-6941-0888 FAX 02-364-0883 E-MAIL webmaster@kosso.or.kr

ADDRESS 04195 서울특별시 마포구 만리재로 14 르네상스 타워 1010호

운영사무국

CONTACT NUMBER 02-2039-5706 E-MAIL ksssoasc2023@into-on.com